

PROFILE SCALE  
 Horiz. 1" = 40'  
 Vert. 1" = 4'

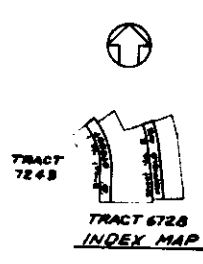

**GENERAL NOTES**

1. All work embodied on these Plans shall be done in conformity with applicable provisions of Specifications No. 8871.
2. All Standard Cross Sections of Curb, Gutter and Pavement are as per City of San Bernardino Dept. of Engineering Std. Div. No. 8881.
3. 8"x4" Wyes with connecting sewer to be cast shown on Plans thru.
4. All sewer lateral main connectors shall be constructed on an upward grade of 2 per cent from the Main Sewer and shall extend from the Main Sewer to the Property Line.
5. Sewer laterals to be constructed of either "Wedge Lock", "Sewer Seal" or "Band Seal" clay pipe or asbestos cement pipe. Sewer mains shall be constructed of either "Wedge Lock", "Sewer Seal" or "Band Seal" clay pipe.
6. All house connections are approximate and exact locations shall be determined in the field.
7. Manhole frames and covers to be constructed by Sewer Contractor 6" below Official Grade shown and upon completion of Paving, the Paving Contractor shall adjust manhole frames and covers to said Official Grade.
8. Manhole steps shall not be required. Manhole Frames and Covers shall be Alhambra Foundry No. A-1170 "Silent Knight" or approved equal.
9. The existence and location of any underground utility pipes or structures shown on these Plans are obtained by a search of the available records. To the best of our knowledge there are no exist utilities except as shown on this Map. The Contractor is required to take due precautionary measures to protect the utility lines shown and any other lines not of record or not shown on this drawing.
10. Bench Mark: Top I.P. @ 6 MAYFIELD AVENUE & South Line Tract No. 5059 elevation 1361.16'
11. Soil tests by a recognized Soil Testing Lab. may be required to determine the adequacy of the indicated subgrade sections. If the results of the tests show the existing subgrade to be inferior, sufficient base material shall be placed to support the indicated surfacing and for the surfacing thickness shall be increased.
12. Ornamental Street Lighting System in accordance with Ordinance 1964 shall be installed as shown on Plan.
13. Subgrade shall be compacted to 95% of density as determined by optimum moisture maximum density.

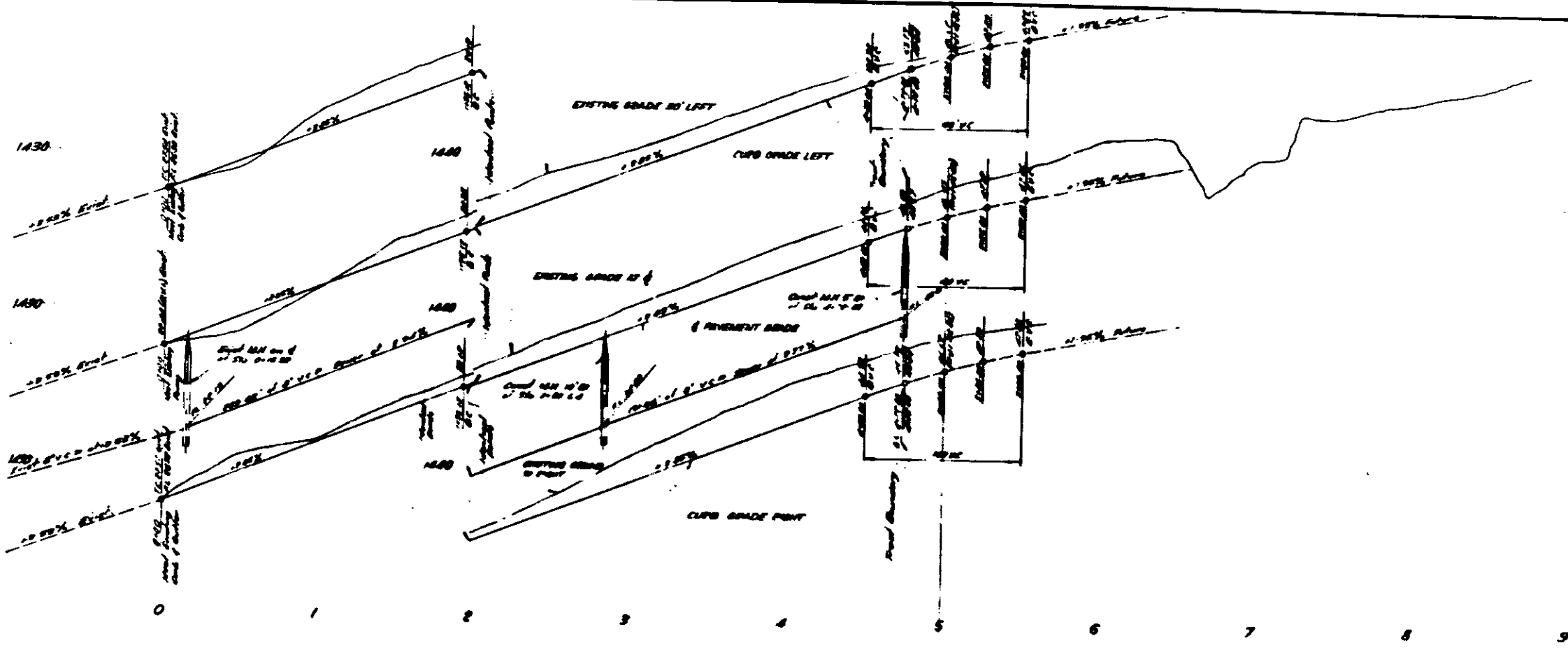
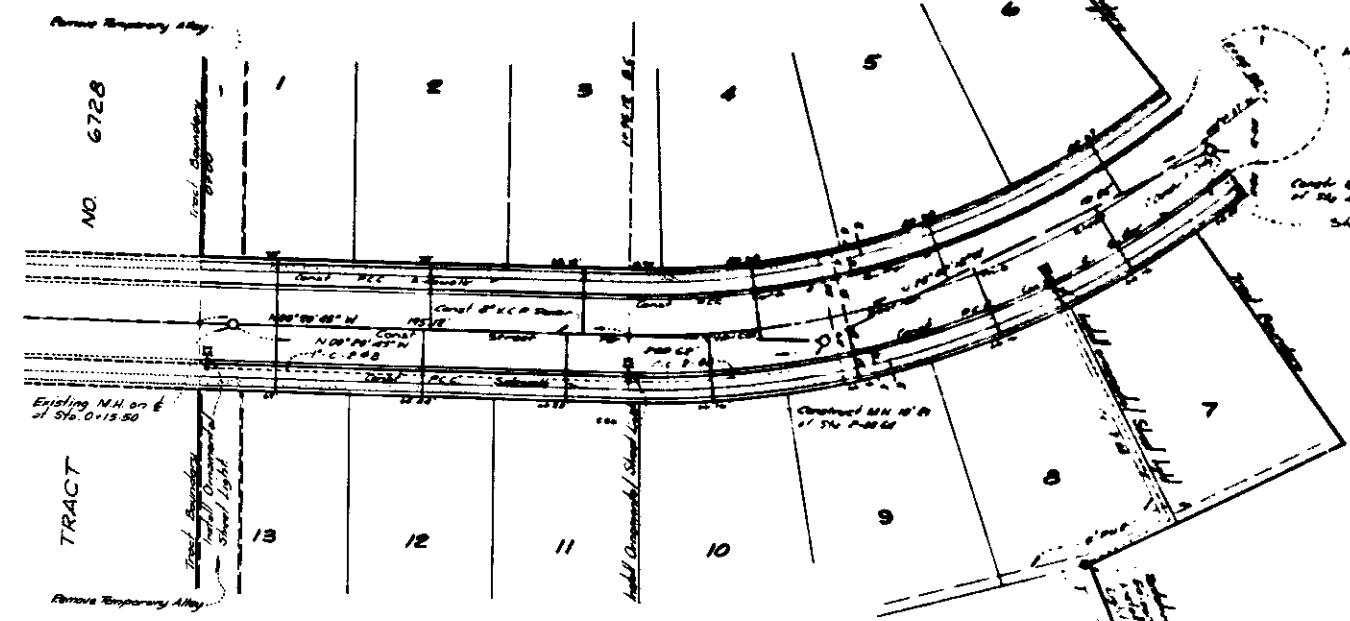
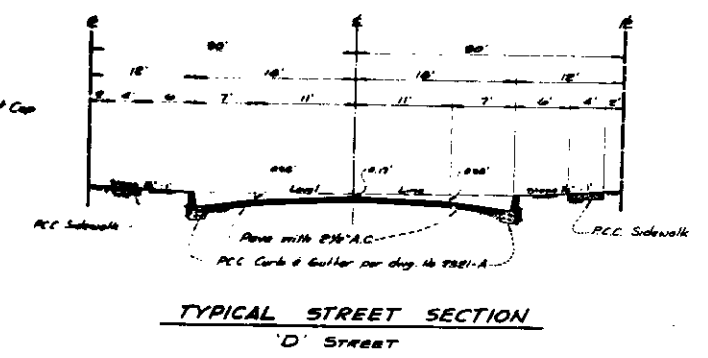

**'D' STREET**

SUBMITTED BY:  
**CAMPBELL, MILLER & ASSOCIATES**  
 CIVIL ENGINEERING, PLANNING & SURVEYING

APPROVED: *[Signature]*  
 CITY ENGINEER  
 REGISTERED CIVIL ENGINEER NO. 3953

DRAWING NO. 3208  
 DRAWN BY: C.L.A.  
 CHECKED BY: D.A.W.

SHEET 1 OF 1

DEPARTMENT OF ENGINEERING  
**CITY OF SAN BERNARDINO**

IMPROVEMENT PLANS  
**TRACT NO 7435**

75-293

75-293